

| Standard Inclusions | |
|---------------------|---|
| Structure | |
| Chassis | Duragal Steel 3200 KG Trailer Tandem Wheels Removable Drawbar |
| Floor | 15mm H3 Ply Floor W/ Sheet Vinyl |
| Walls & Roof | Fiberglass Skinned Composite Panel |
| Capping | Powder Coated Aluminium |
| Fixing | Modified silane polymer adhesive sealant |
| Openings | |
| Windows | Standard Aluminium w/Toughened glass Insect Screens |
| External Door | 1 Lite Timber Door |
| Internal Doors | Flush Doors on Surface Sliding Rails |
| Kitchen | |
| Cabinetry | Underbench Cupboard 3900 Overhead 2260 600 Deep Bench 1660 750 Deep Bench 2250 Breakfast bar 2250 Open Shelves 900 Fridge Space 600 |
| Items | Stainless Steel Sink w/ Mixer Induction Cooktop |
| Bathroom | |
| Cabinetry | Linen Cupboard 600 Underbench 300 Overhead 900 Waching Machine Space |
| Shower | 1000x800 Shower w/ Mixer |
| Toilet | Standard Flushing Toilet |
| Sink | Stainless Steel Sink w/ Mixer |
| Rails | 600mm Towel Rails Toilet Paper Holder |
| Living | |
| Cabinetry | Open Shelf 450 |
| Lounge Space | Open Space 2260 |
| Bedroom | |
| Cabinetry | Full Height Shelving 450 Half Height Shelving Hang Over 450 Full Height Hanging 400 |
| Bed Space | Queen Sized bed 2/400 wide bedside table |
| Electrical | |
| Kitchen | 4 Double Powerpoints |
| Bathroom | 2 Double Powerpoints |
| Living | 2 Double Powerpoints |
| Bedroom | 2 Double Powerpoints |
| Lighting | Wireless LED Lighting throughout |
| Supply | 15 Amp Caravan Socket |
| Plumbing | |
| Hotwater | 80L Storage Hotwater |
| Supply | Plug-in 15mm Pipe |
| Sewer | All outlets exposed to underside of floor ready to be connected to existing sewer |
| External | |
| Finish | Gloss White Fiberglass Contrasting Colorbond feature around Entry, Breakfast bar windows and Bedroom |

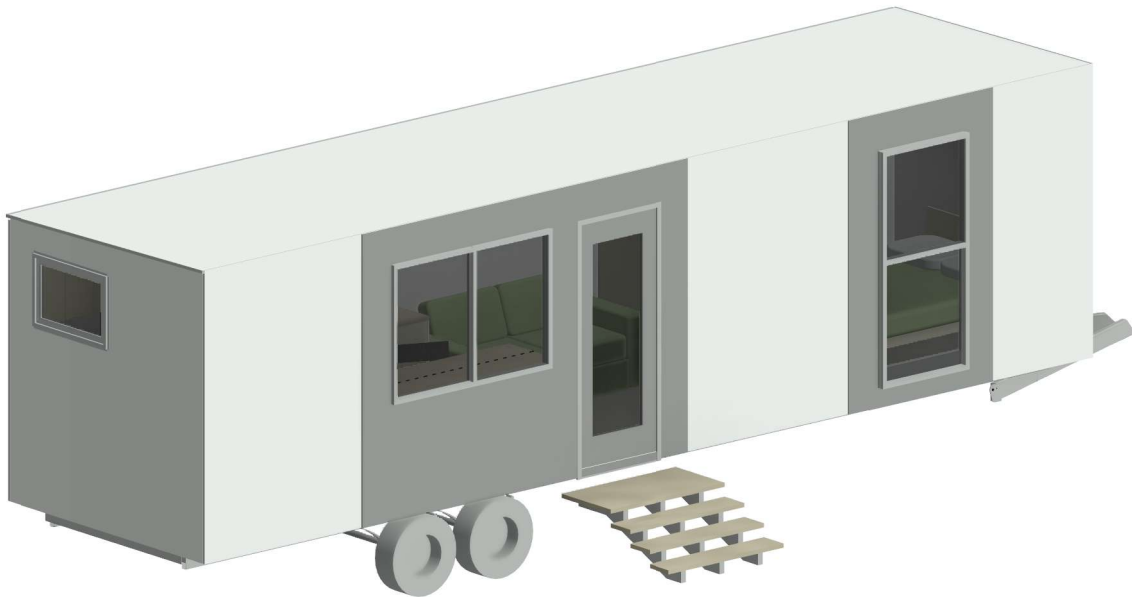
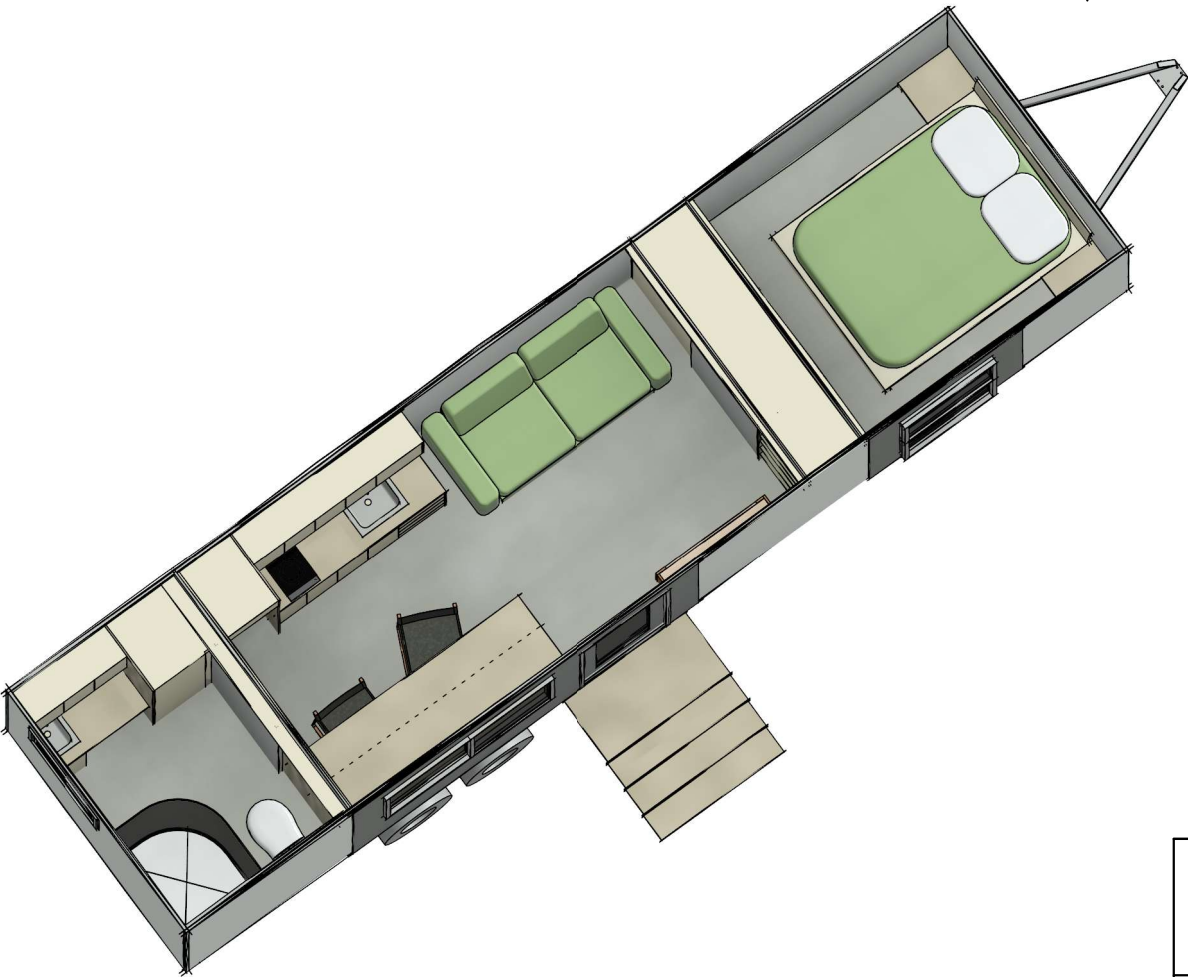
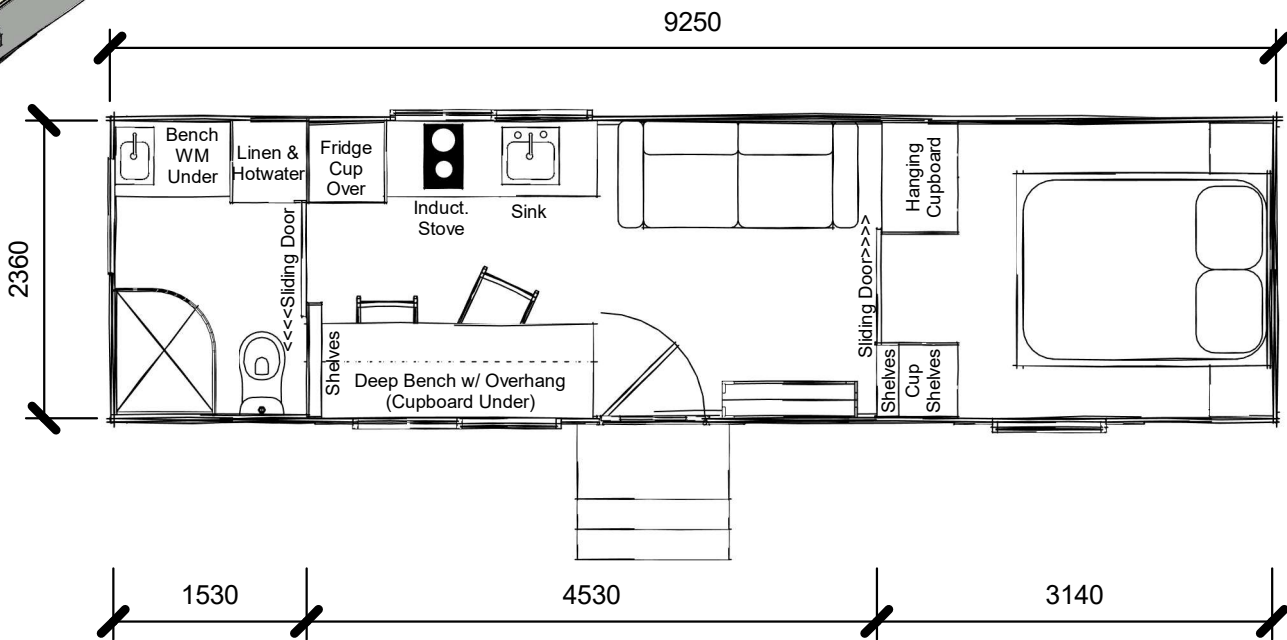
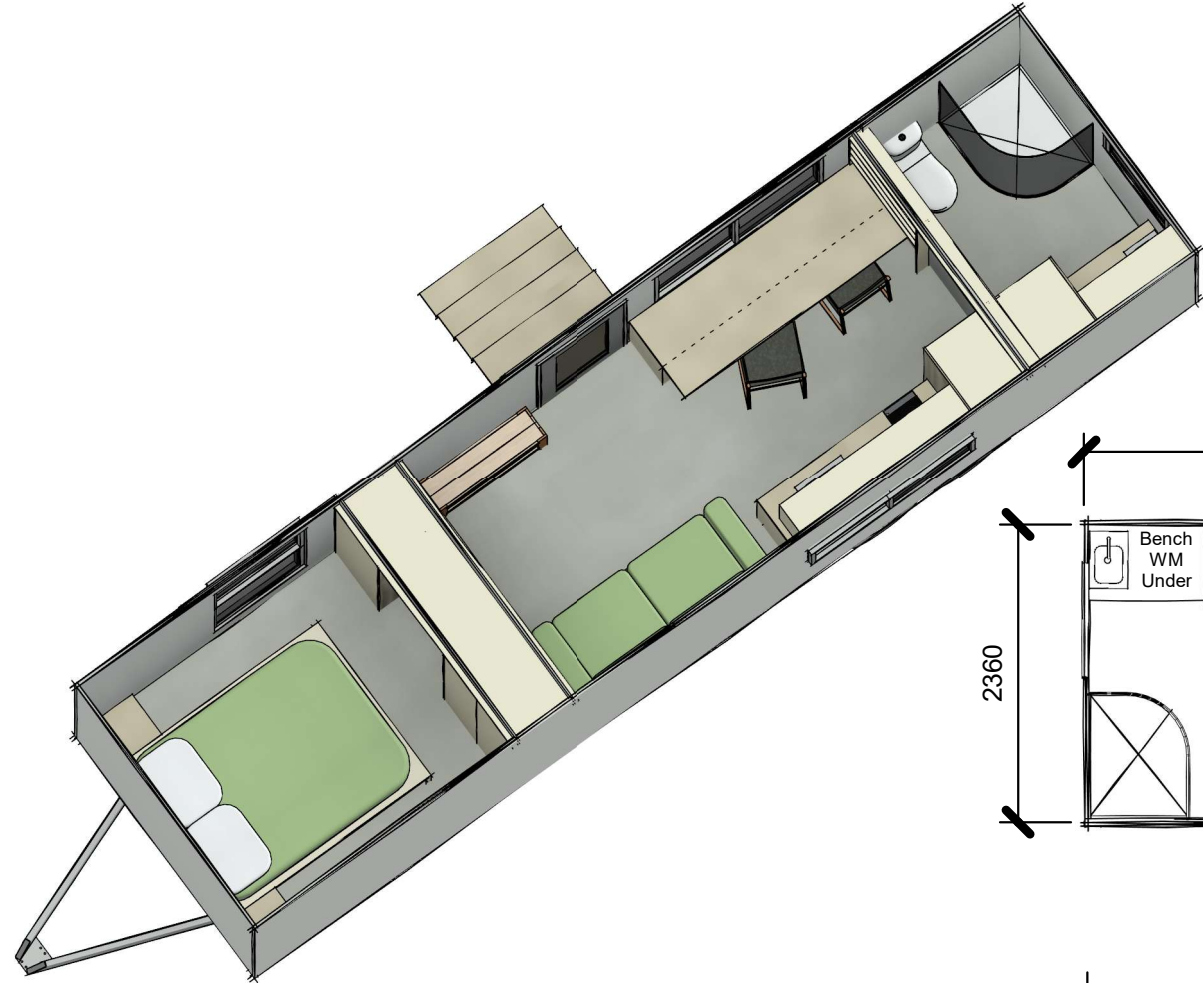

Project: The PIVOT

Scale: 1 : 60

Drawn By: AP

Date: 29/11/25

Sheet Number: A101 - Concept

Drawing Number: 251120

HOVAN

m| 0493 424 752 e| sales@hovan.com.au